

**ATTACHMENT B**

**CONSULTATION BOARDS –  
DESIGN AS EXHIBITED**

# Thomas Street, Chinatown - Overview

## Project Background

Chinatown is one of Sydney's most unique and well loved destinations. It is a significant cultural and social hub for residents, workers and visitors to the area.

A Public Domain Plan for Chinatown has been developed in consultation with the community. The Plan celebrates the unique character and heritage of Chinatown and creates more space for pedestrians, public art, outdoor markets and events. Improvements and traffic changes to Thomas Street between Hay Street and Quay Street is the next project to be undertaken as part of the Chinatown Public Domain Plan.

Thomas Street will be converted to an open space for pedestrians, a place for people to meet, rest and enjoy public art.

The curatorial theme for this space is "New Century Garden". The theme was developed to guide the overall artistic vision for the project.

The vision for Thomas Street is:

A garden for the new century,  
shaped by Chinese Buddhist and Taoist philosophy  
invoking the elements of fire and water with native flora.

## Project Objectives

- Maintain and enhance the open street life in Chinatown, embracing its lively, exciting and culturally rich character
- Recognise past and present cultural identity through architecture, place design and public art
- Improve civic life and urban amenity
- Create a place where public art becomes part of the fabric
- Strengthen pedestrian connections to Hay Street and Dixon Street
- Improve the quality of the streets
- Provide generous public gathering spaces and opportunities for flexible uses.
- Provide sufficient parking / loading requirements



Context Map

# Thomas Street, Chinatown - Site History

## The Chinatown Precinct



**1807** Map showing former harbour edge, Darling Harbour & the Harris Estate.



**1890** Site plan with Ultimo Estate street pattern. The Harris Estate subdivision allowed the area to develop as warehouses & terraces.



**1917** Site plan showing resumptions & city market. Council resumed many blocks to construct the new city markets.

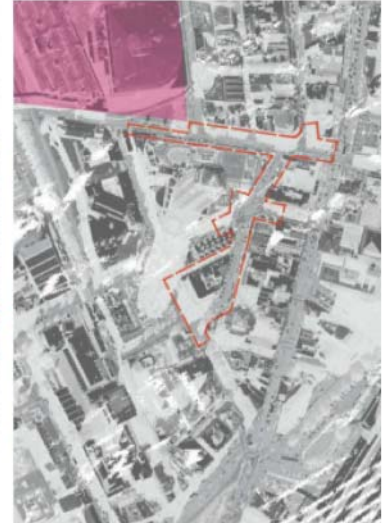

**2013** Aerial map showing today's condition. As the markets leave, new developments trade on the area's lively character.

## Thomas Street



**1800's** Shanty houses.



**1945** Aerial view of Thomas Street and Hay Street showing vistas to towers on street corners.



**1980** Thomas Street showing axial view to corner tower.



**2013** Thomas Street today with east side of street maintaining vibrant character.

## Hay Street



**1800's** Hay Street during construction of markets.



**1932** The markets at their peak.



**1985** Hay Street prior to Market City.



**2013** Hay Street today with Market City & tramline

# Thomas Street, Chinatown - Big Ideas

## Core principles



### 1) Interconnectivity

The basic principle of design will be interconnection – between city and nature, the individual and cosmos, history and contemporary, tradition and innovation.



### 2) Flow

Flow refers to movement within and through relationships of interconnectivity. It is acknowledged in the principles of Feng Shui, which are important to the Chinatown community. The garden will be designed in such a way as to facilitate flow: it can contain a density of energy while providing a calming and serene influence.

The predominant image for the New Century Garden is The River. A river flows, finds its own course and acts as a conduit. It contracts and expands, provides nourishment, sustains life and gives respite and movement.



### 3) Identity

In expressing Chinese-Australian identity, we understand traditional and contemporary to be part of a continuum and not in opposition. The acknowledgement of this continuum embraces vitality and allows us to create a living space in which the future will unfold.

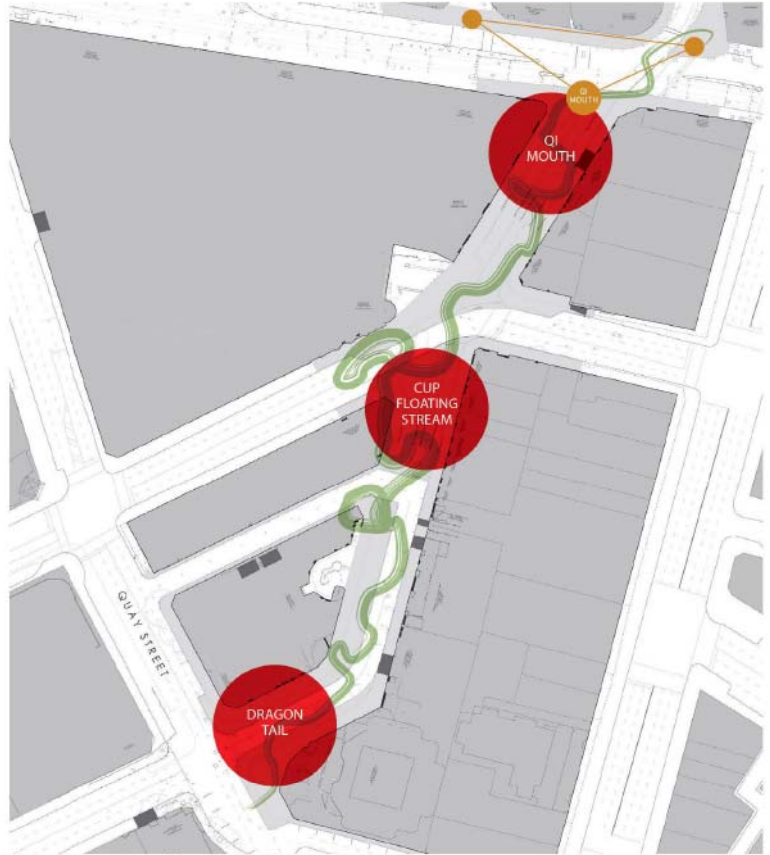

Thomas + Hay Street - Artistic Vision

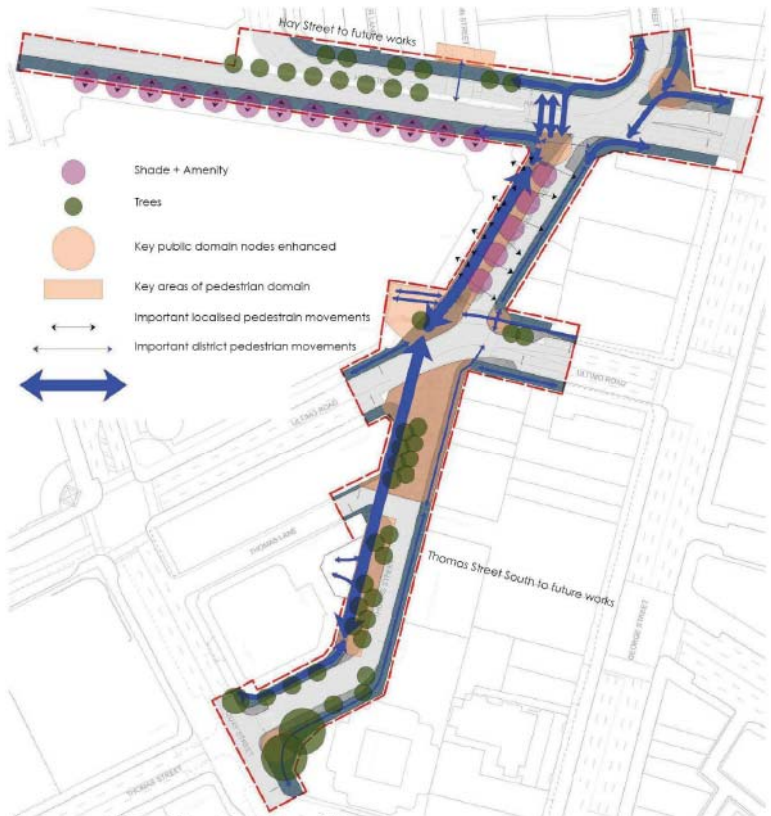

Thomas + Hay Street - Urban Structure

# Thomas Street, Chinatown - Artist Impression



Thomas Street North



Thomas Street South

# Thomas Street, Chinatown - Key Areas

Thomas street plan

## Design Statement

The design proposal for Thomas Street creates a more generous and engaging pedestrian experience.

A new public space on Thomas Street (between Ultimo Road and Thomas Lane) as a result of a proposed shared zone and timed road closure prioritises this area for pedestrians and creates an area of respite.

A widened footpath on the western side of Thomas Street between Hay Street and Ultimo Road will create a strong pedestrian connection to the heart of Chinatown. The removal of parking on the western side of Thomas Street will allow more space for gathering and activation adjacent to Market City. Vehicular access and loading zones on Thomas Street will be retained to support businesses.

Art work is integrated in these spaces, enhancing amenity such as shade and seating and creating a distinctive space.

Vehicular access to garages is retained and loading to support existing businesses is maintained.

High quality granite flagstone paving and sets, stone kerbs and new street furniture will be installed.

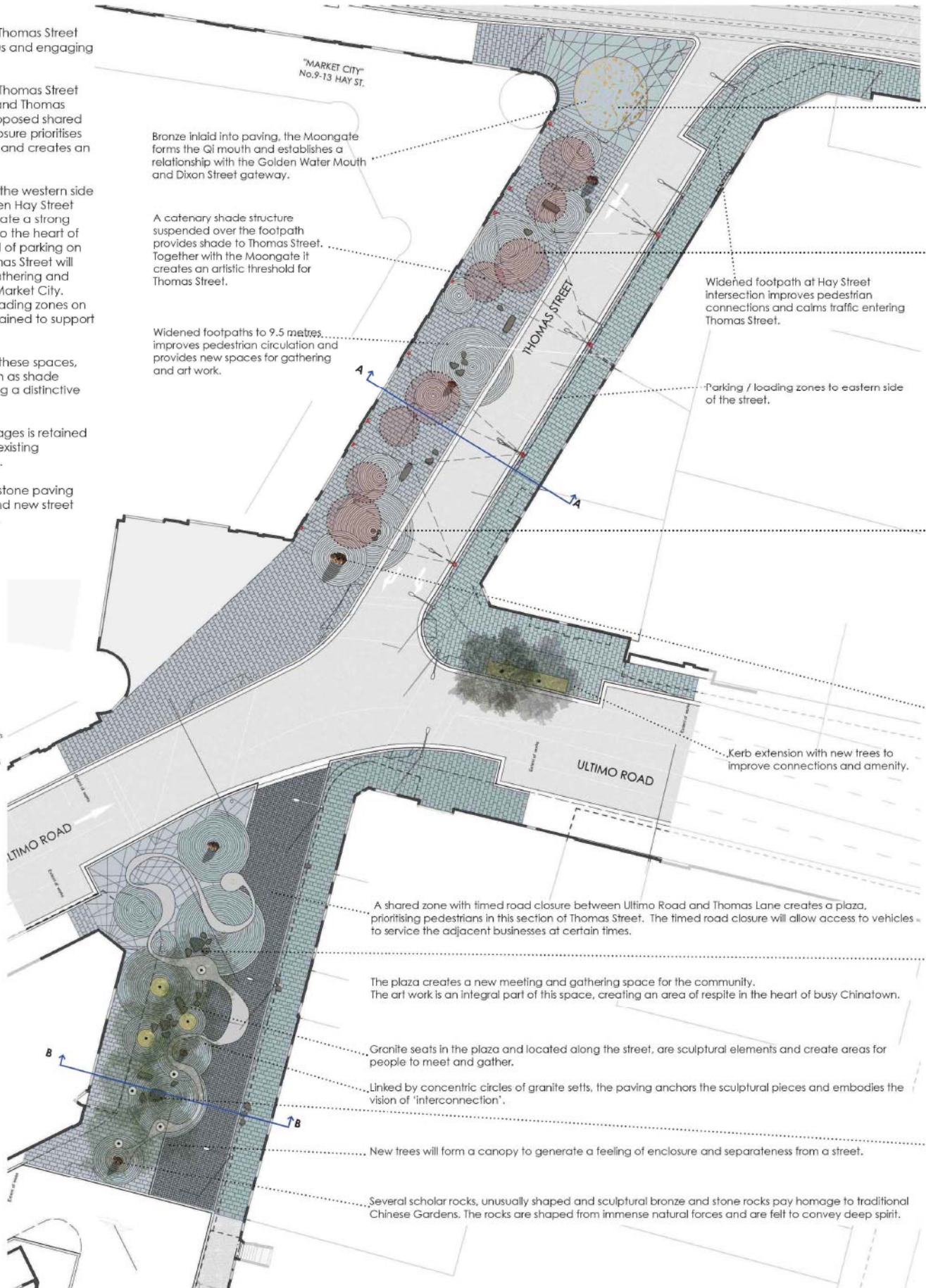

Bronze inlaid into paving, the Moongate forms the Qi mouth and establishes a relationship with the Golden Water Mouth and Dixon Street gateway.

A catenary shade structure suspended over the footpath provides shade to Thomas Street. Together with the Moongate it creates an artistic threshold for Thomas Street.

Widened footpaths to 9.5 metres improves pedestrian circulation and provides new spaces for gathering and art work.

Widened footpath at Hay Street intersection improves pedestrian connections and calms traffic entering Thomas Street.

Parking / loading zones to eastern side of the street.

Kerb extension with new trees to improve connections and amenity.

A shared zone with timed road closure between Ultimo Road and Thomas Lane creates a plaza, prioritising pedestrians in this section of Thomas Street. The timed road closure will allow access to vehicles to service the adjacent businesses at certain times.

The plaza creates a new meeting and gathering space for the community. The art work is an integral part of this space, creating an area of respite in the heart of busy Chinatown.

Granite seats in the plaza and located along the street, are sculptural elements and create areas for people to meet and gather.

Linked by concentric circles of granite sets, the paving anchors the sculptural pieces and embodies the vision of 'interconnection'.

New trees will form a canopy to generate a feeling of enclosure and separateness from a street.

Several scholar rocks, unusually shaped and sculptural bronze and stone rocks pay homage to traditional Chinese Gardens. The rocks are shaped from immense natural forces and are felt to convey deep spirit.

- NEW ASPHALT FOOTPATH PROMENT
- CITY OF SYDNEY STANDARD FLAGSTONE PAVING ALBINO BLOCK
- CITY OF SYDNEY MODIFIED FLAGSTONE PAVING ALBINO BLOCK
- GRANITE SETS
- CONCENTRIC CIRCLE PAVING Granite sets set in concrete matrix
- NEW STREET TREE Rectangular Ginkgo biloba
- NEW STREET TREE Columnar acacia
- MONUMENTAL BRONZE AND STONE BLOCK PAVING
- STONE SEAT Shallow trapezoid with half and pedestal
- CAST BRONZE SCHOLAR STONE
- PEDESTRIAN LIGHTING
- STREET LIGHTING
- CUP FOOTING STRIP/Paving pattern profile
- STREET BOUNDARY
- PAVING AND/OR TO BE REPAIRED
- EXISTING KERBSIDE
- CANOPY STRUCTURE
- ASPHALT ROAD PAVEMENT REQUIRED
- TREE PIT WITH GARDEN BED
- CIRCULAR STONE SETTING
- STANDARD CITY OF SYDNEY TREE PIT

# Thomas Street, Chinatown - Key Areas



The Moon Gate

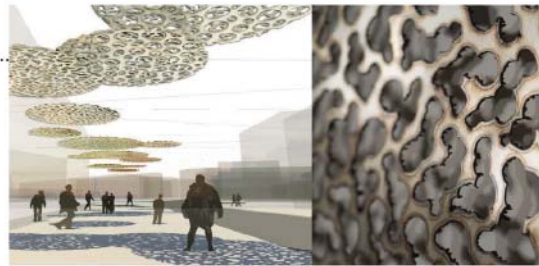

Catenary Shade Structure



Concentric Circles Paving



Scholar Rock



Granite Seating



Cup Floating Stream

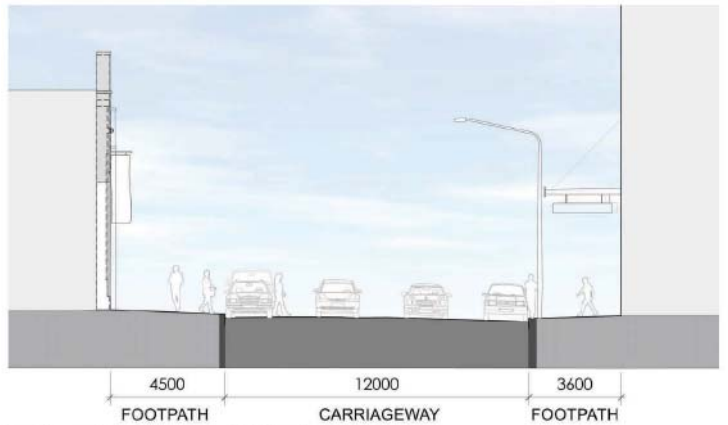

Section AA - Thomas St North Existing

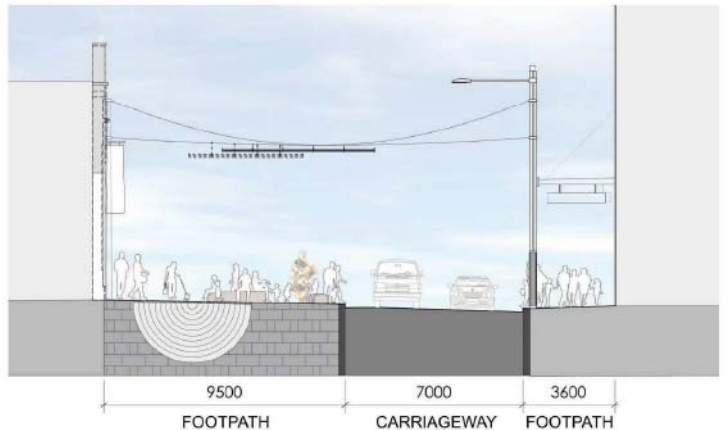

Section AA - Thomas St North Proposed

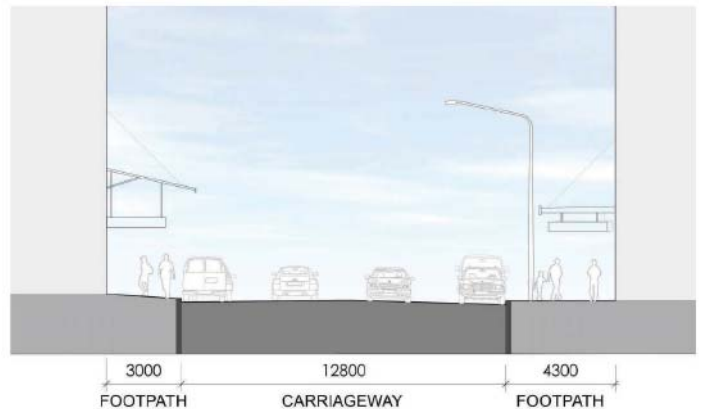

Section BB - Thomas St South Existing

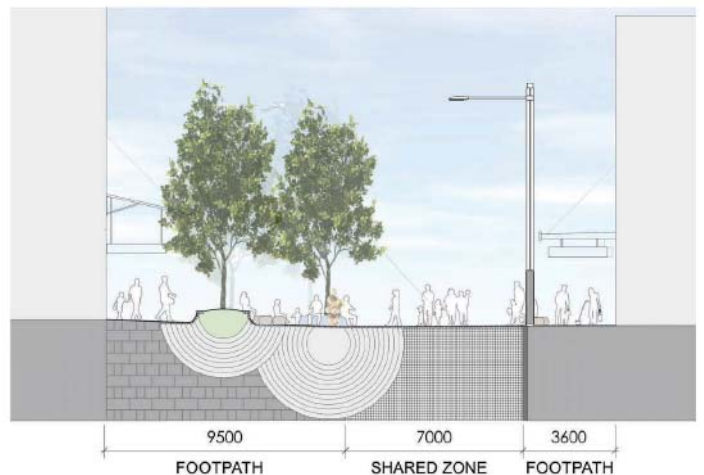

Section BB - Thomas St South Proposed

# Thomas Street, Chinatown - Parking/Traffic

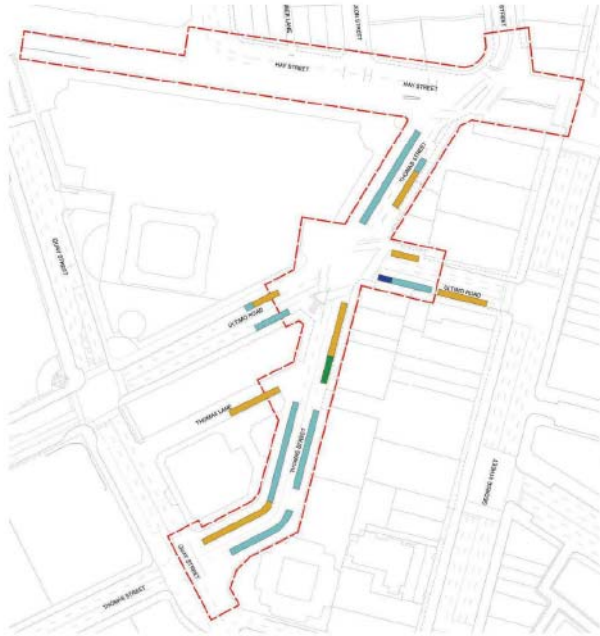

Existing spaces

16	Loading/parking	18
25	Parking	15
2	Carshare	2
1	Bus	0

Existing Parking

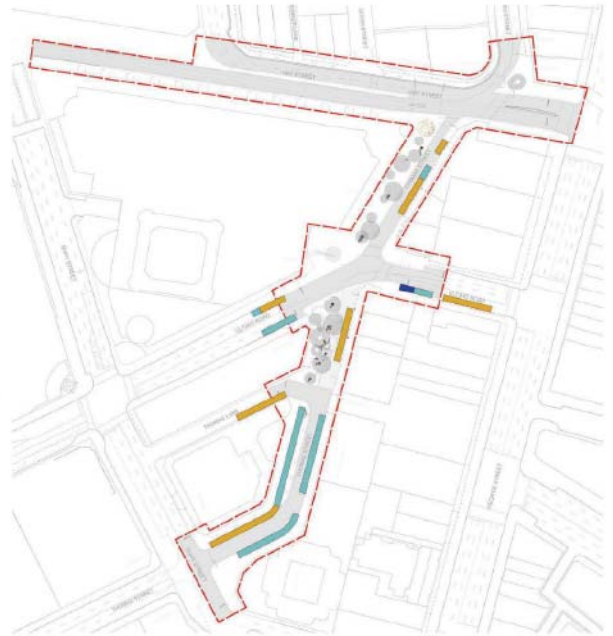

Proposed spaces

18	Loading/parking	15
15	Parking	2
2	Carshare	0
0	Bus	

Proposed Parking



Legend

- Existing travel lanes and direction

Existing Traffic Condition



Proposed Traffic Condition

**Proposed traffic changes**

- Shared zone timed road closure between 7.00am – 10.00am (3 hours); 12.00pm – 2.00pm (2 hours); and 4.00pm – 4.00am the following day (12 hours). Access via left-turn only from Ultimo Road east
- No through traffic southbound at Thomas Street and Ultimo
- Traffic lanes reduced from 3 lanes to 2 lanes southbound from Hay Street to Ultimo Rd
- One way southbound flow on Thomas Street between Thomas Lane and Quay Street;



# Thomas Street, Chinatown - Materials

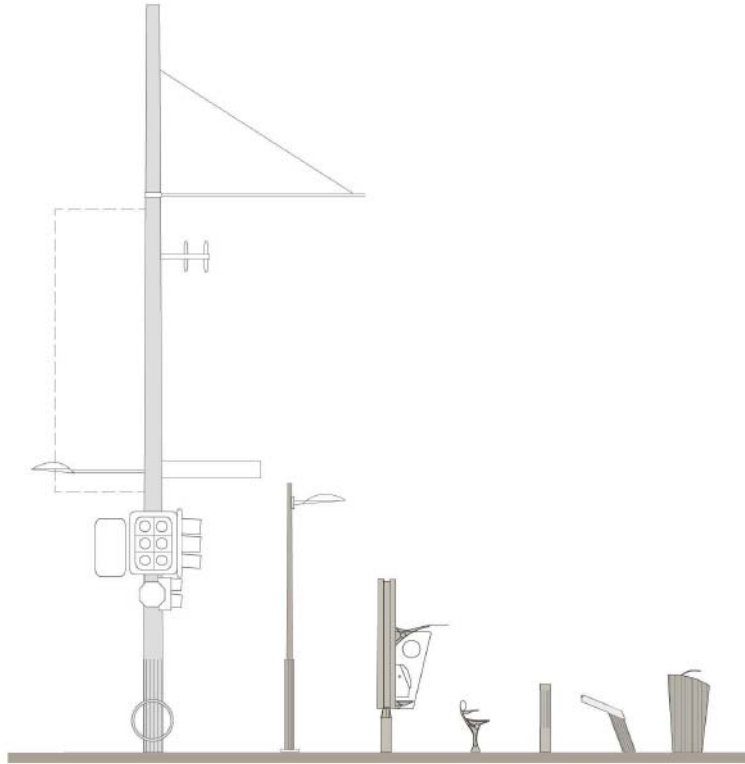

City of Sydney Street Furniture



City of Sydney Standard Flagstone Paving  
Austral Black



City of Sydney Modified Flagstone Paving - Austral Black



Concentric Circle Paving  
Granite sets laid in concentric circles



Granite Setts



New Asphalt Footpath Paving



Cast Bronze Scholar Stone



New Stone Kerbs

Pavement Materials



Tibiarkops laurina 'Luscious' flowers



Tibiarkops laurina 'Luscious'  
Water Gum

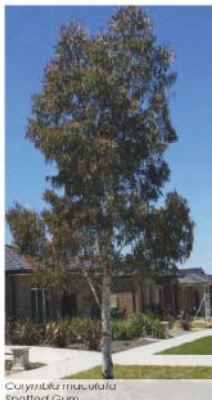

Corymbia maculata  
Spotted Gum



Corymbia maculata  
Feature Bark

Street trees

# Thomas Street, Chinatown - Next Steps

## Next Steps

We will use your feedback on the plan to develop the detailed design

The plan is open for comments until **3 June 2013**

Send your comments to: Kee Li  
email - [Kli@cityofsydney.nsw.gov.au](mailto:Kli@cityofsydney.nsw.gov.au)  
fax - 9265 9566  
post - GPO Box 1591  
Sydney NSW 2001

You can also see the plan at:  
[www.sydneyoursay.com.au](http://www.sydneyoursay.com.au)

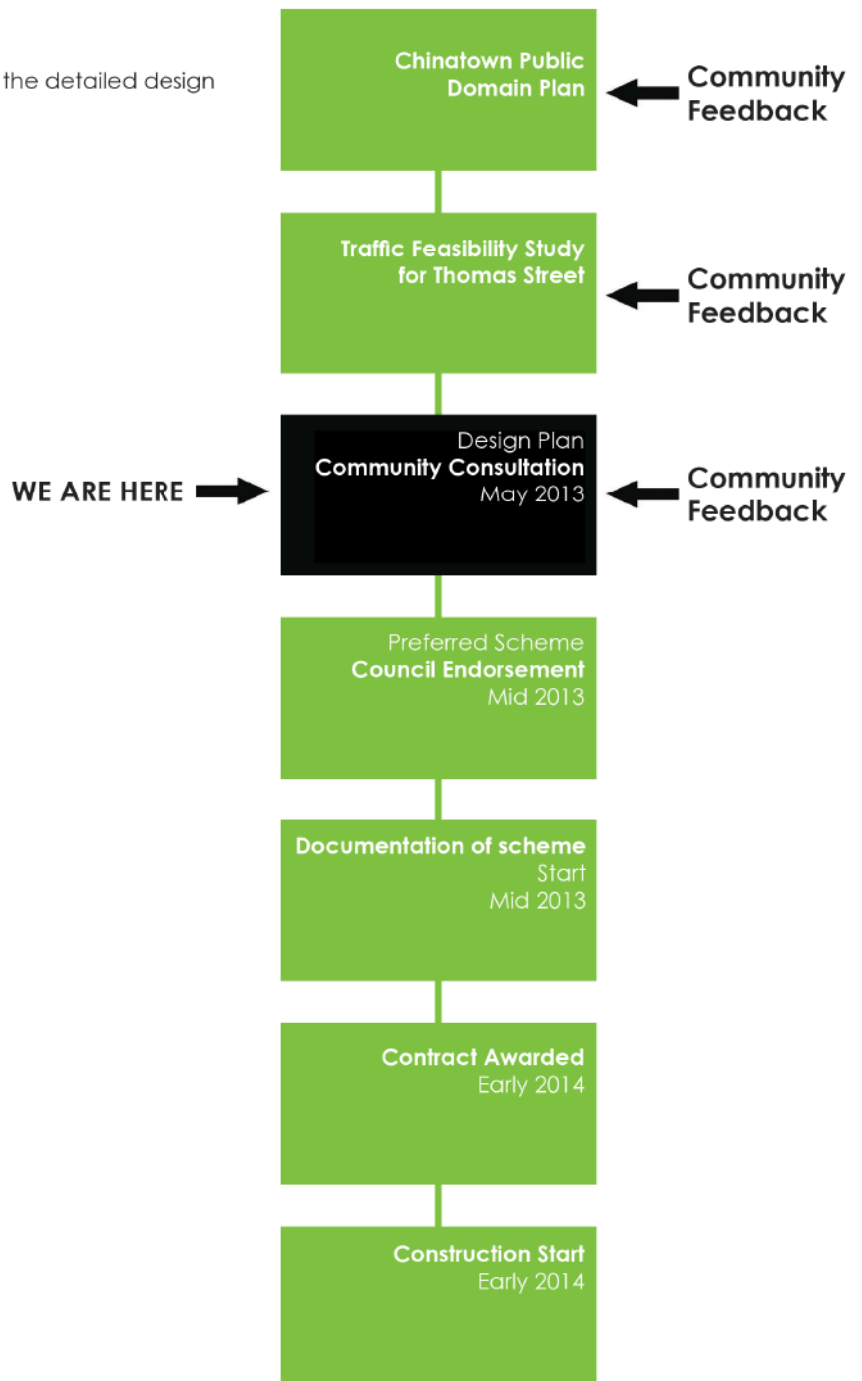

**Postal Address**  
City of Sydney  
GPO Box 1591 Sydney NSW 2001

**Website**  
You can also view these plans and make comment online at:  
[www.sydneyoursay.com.au](http://www.sydneyoursay.com.au)

**General Enquiries**  
Tel 9265 9333  
[council@cityofsydney.nsw.gov.au](mailto:council@cityofsydney.nsw.gov.au)  
[www.cityofsydney.nsw.gov.au](http://www.cityofsydney.nsw.gov.au)

If you would like to speak to a council officer about this project you can contact Gabriella Monagle, Project Manager on 9246 7825 or at [gamonagle@cityofsydney.nsw.gov.au](mailto:gamonagle@cityofsydney.nsw.gov.au)